

\$25.00

LOW MAINTENANCE LANDSCAPE *inc.*

785.550.5610

INNOVATIVE LANDSCAPE DESIGN
QUALITY GARDEN CONSTRUCTION
MAINTENANCE AND CONSULTATION
NATURAL STONE AND BRICK PATIOS
RETAINING WALLS AND WATER FEATURES
IRRIGATION, DRAINAGE AND LIGHTING
DECK, FENCE AND PERGOLA CONSTRUCTION
LANDSCAPE ARCHITECTURE DEGREE
EXTENSIVE HORTICULTURAL KNOWLEDGE
OVER 20 YEARS DIVERSE EXPERIENCE

Visit our web site at: LowMaintenanceLandscape.net



ABOUT OUR COMPANY

Our landscape design / build firm takes pride in offering high quality services to homeowners in Lawrence and surrounding Douglas county areas. We exercise a caring approach to create gardens that are both low maintenance and long lasting. This saves you money over the years and is friendly to our environment. We're proud to be a "green" company with native plant expertise.

With our help, we can give your home that beautiful, mature, and unique look that will have your neighbors asking who did it! An attractive professionally designed landscape can add 10-15% to your home value. Protect your investment while creating a beautiful place to relax and live.

We take pride in operating a small, locally owned business. Offering the best customer service and superior quality work is our top priority. We maintain a low overhead operating cost and are therefore able to design and install your landscape for less than you think. Refundable landscape design fees start at \$400. We specialize in constructing projects that range in cost from \$2,500 to \$10,000 and up. As an ongoing service to our customers, we also offer landscape maintenance to help keep your gardens beautiful. Simple projects not requiring a design can be estimated for free and we can work competitively with any budget over \$1500.

We hope that by adding you to our list of satisfied customers, you will tell your friends and family about our excellent work. Let our professional with a 5 year degree in landscape architecture and over 30 years of experience take care of you! We thank you for many great years of business since 2001.



2

OUR CREDENTIALS:
DEGREE IN LANDSCAPE ARCHITECTURE
EXTENSIVE HORTICULTURAL KNOWLEDGE
FULLY INSURED AND LOCALLY OWNED
LOCALLY GROWN PLANTS IN LAWRENCE
OVER 30 YEARS DIVERSE EXPERIENCE
IN BUSINESS SINCE 2001



OUR FIRST LANDSCAPE, 2001

INNOVATIVE LANDSCAPE DESIGN/BUILD

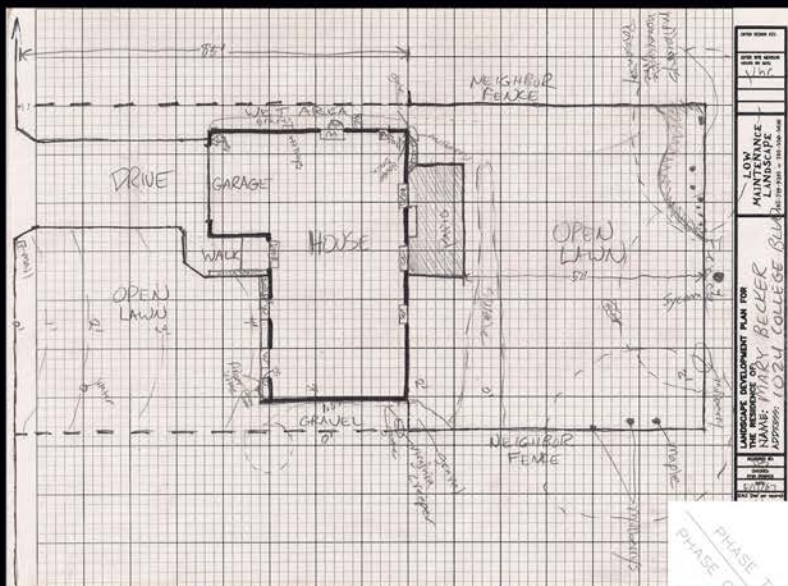

We offer landscape design service that is customized around your needs and desires. The newest movement in landscape architecture is self-sustainable, low maintenance landscaping. Whether it be simplistic and functional or lush and beautiful, we can make the dream happen for you. Our design fees usually range from \$400-\$1000 and are fully refundable with installation contract.

STEP 1; INITIAL CONSULTATION, SITE MEASURE, ANALYSIS AND CONCEPTUAL DESIGN IDEAS

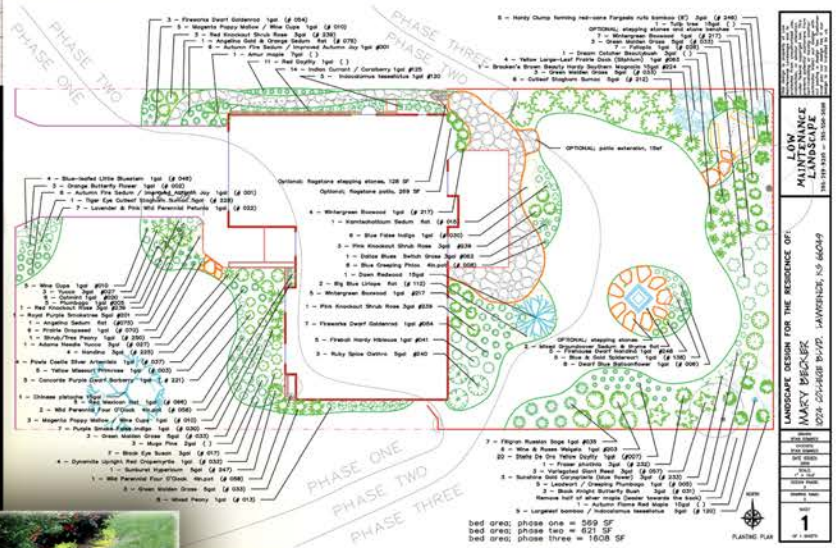

STEP 2; FINAL DESIGN, ESTIMATE, PRESENTATION AND CONTRACT PREPARATION



STEP 3; BREAKING GROUND; INSTALLATION AND CONSTRUCTION

Visit our web site at: LowMaintenanceLandscape.net

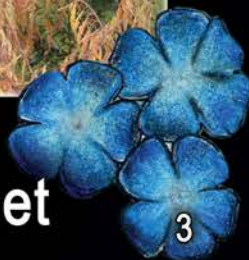

LANDSCAPE PROJECTS: BEFORE AND AFTER

We have the vision to totally transform your landscape. We see the potential in every project we take on. We love what we do and it shows. This is what we can do for you!



BEFORE



AFTER



BEFORE



AFTER



BEFORE



AFTER

HOW YOUR LANDSCAPE CHANGES EACH SEASON

Our landscape projects look attractive during all 4 seasons. It's easy for an amateur to plant something that looks good in the spring when they first purchased it. The real challenge is to design a landscape that thrives in our difficult climate and remains appealing all year long, especially during winter.

SPRING



FALL



SUMMER



HOW YOUR LANDSCAPE GROWS OVER THE YEARS

Our landscape projects look good the day they are completed. It is also very important that they still look good many years later. Our projects are designed to be self-sustainable over the long term and fill in gradually with time. We have the knowledge and talent to know how it will look in the future when designing it today.



NEW CONSTRUCTION AND PLANTING



PICTURED 5 YEARS LATER

Visit our web site at: LowMaintenanceLandscape.net

HARDSCAPE CONSTRUCTION



A hardscape is any permanent stone structure or component of your landscape. Low Maintenance Landscape specializes in the art of building hardscapes from natural stone. We design hardscapes to add function, usefulness, added outdoor living space, and long lasting beauty to your property. We can build any of the following; natural flagstone patios, stepping stone paths, antique brick patios, stone retaining walls, seatwalls, stone outcroppings, stone edging, dry riverbeds, accent boulders, stone fire pits and fireplaces.

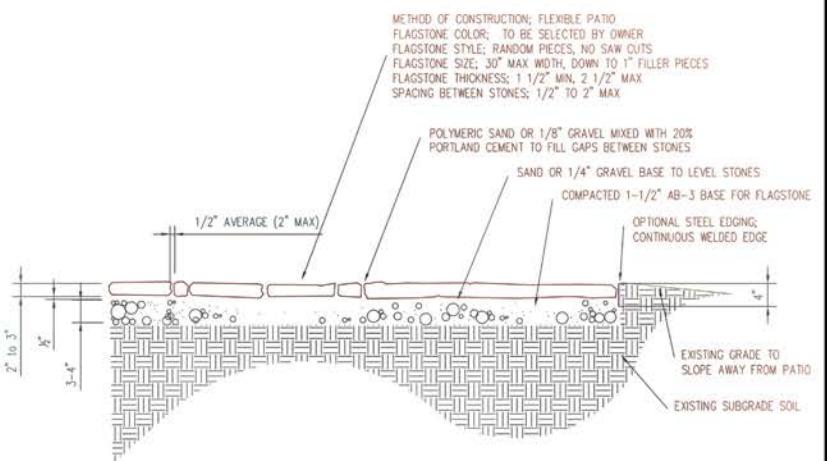

3

FLAGSTONE PATIO / WALK ON AB-3 BASE, STEEL EDGE

DRAWN BY: RYAN DOMNICK

SCALE: N.T.S.



NATURAL FLAGSTONE PATIOS

At Low Maintenance Landscape, flagstone patio construction work is the best quality you will find. There are several characteristics to a good quality patio and if you scrimp on even one of them, the entire patio is compromised. Our flagstone patios are constructed using 2-3" thick, high quality hardened sandstone slabs measuring up to 5' across. The spacing between stones averages only 1/4" and is constructed on a 6" thick base composed of AB-3 and sand. This may sound technical, but we believe you should know all the details before investing thousands of dollars in a beautiful flagstone patio that will last a lifetime.

Visit our web site at: LowMaintenanceLandscape.net

STONE RETAINING WALLS AND SEATWALLS

Sloping sites can present real problems including runoff and erosion. It can also be challenging to find ways to use this property. Sites like this can really benefit from the construction of a retaining wall to provide more level planting and recreation areas. We construct beautiful natural stone retaining walls using a variety of stone ranging from naturalistic to more formal. A seatwall is basically a freestanding or retaining wall with a flat surface built into it for sitting. These beautiful features create an ideal setting for entertaining your family and friends.



NATURAL STONE OUTCROPPINGS AND BOULDERS

We have an eye for creating realistic looking stone outcroppings similar to what you'll see in nature. A well constructed stone outcropping serves the purpose of a retaining wall by slowing runoff and reducing erosion. The difference is that an outcropping looks more natural; like it has always been there.

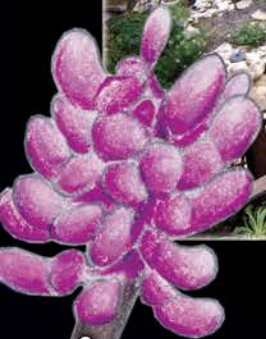

STONE FIREPITS AND OUTDOOR FIREPLACES

We design and construct fire pits and fireplaces that help create the feel of an outdoor room. An outdoor fire feature will provide you a cozy and romantic place to harness the warmth and light of an open fire. Your kids will enjoy the fun and responsibility of having campfires and roasting marshmallows.



DECORATIVE CONCRETE

We can design and subcontract high quality decorative concrete patios. We usually recommend a natural earthlike slate texture and brown or beige color.

STONE EDGING

Stone edging can be installed around a bed area to help give it structure and form. It also helps keep mulch in your bed on sloped sites. Many of our beds are fine with or without edging but if you prefer a border, we prefer the beauty of natural stone.



Visit our web site at: LowMaintenanceLandscape.net



WOOD CONSTRUCTION, DECKS, FENCES, PERGOLAS

Low Maintenance Landscape provides high quality design and construction of fences, decks and pergolas. Using only the finest materials, our company will provide you and your family with a beautiful addition to your property that can be enjoyed for many years.

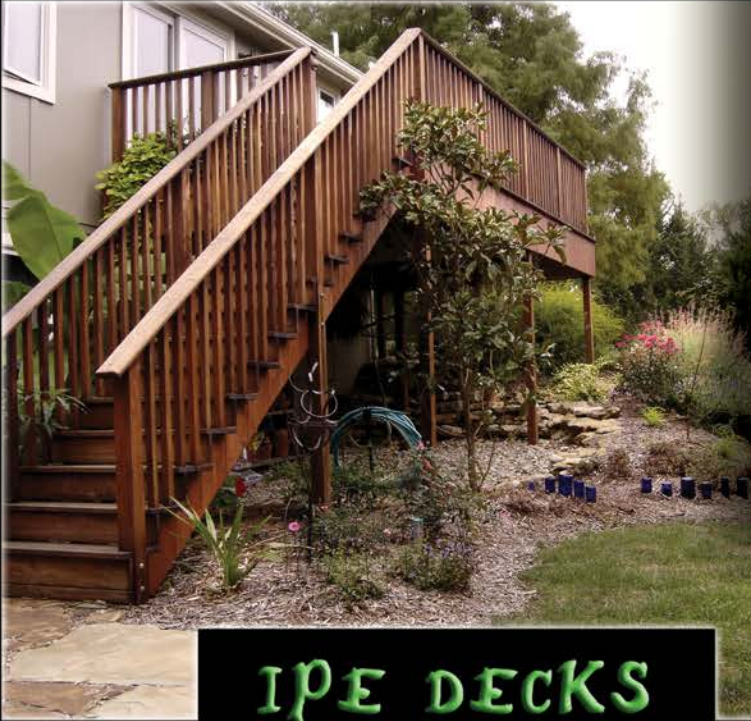

IPE DECKS

Decks are one of the most rewarding home improvement projects you can have installed at your home. We specialize in the construction of IPE decks; the world's most durable hardwood. This amazing wood is a wonderful "green" building product due to its ultra low maintenance properties, 50+ year lifespan and sustainable reforestation.

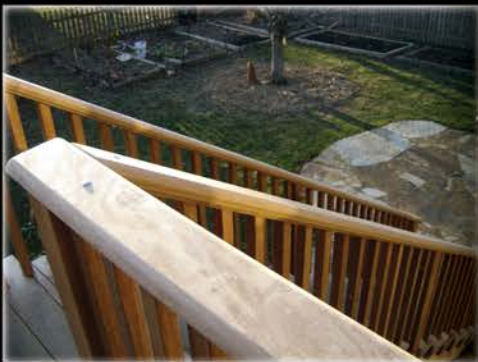

ADVANTAGES OF IPE HARDWOOD DECKS

1. IPE has natural decay resistance; it does not contain dangerous chemical preservatives.
2. IPE is an incredibly tight grained, dense, strong wood that has the same fire rating as concrete.
3. IPE is more cost effective than you may think; about the same as a redwood or composite deck.
4. This amazing "organic" hardwood is a "green building material" with a lifetime guarantee.
5. Maintenance free; optional IPE oil may be applied yearly to maintain natural reddish brown color.



CEDAR FENCES

A fence helps define our outdoor living space and gives us privacy in our crowded suburban neighborhoods. Our cedar privacy fences are built exceptionally strong with 16 foot alternating runners, galvanized screws, and reinforced sag-free gates. Our fence will be the one still standing after the big storm!



CEDAR PERGOLAS

A rough cedar pergola will add that "outdoor room" to your house for a fraction of the cost of a room addition! What a perfect way to shade your deck without waiting for a shade tree to grow! Pergolas also create the perfect place for a backyard grape vineyard.



Visit our web site at: LowMaintenanceLandscape.net

IRRIGATION SYSTEMS



While most of our landscape plantings are designed to thrive without added water, installing an irrigation system will free up your time and give you control over watering during drought. Irrigation systems also add value to your home. We build top quality trouble-free systems that are designed to



last for decades. Our systems are built with PVC pipe and Rain Bird® heads. To avoid costly damage later, all pipes are buried extra deep.

PROFESSIONAL LANDSCAPE LIGHTING

Low voltage landscape lighting is far more than just putting out a few lights. Our professional landscape lighting can add an entire new dimension of beauty to your property that you may have never considered. Many of us work during the day and only have time to enjoy the landscape during evening hours.

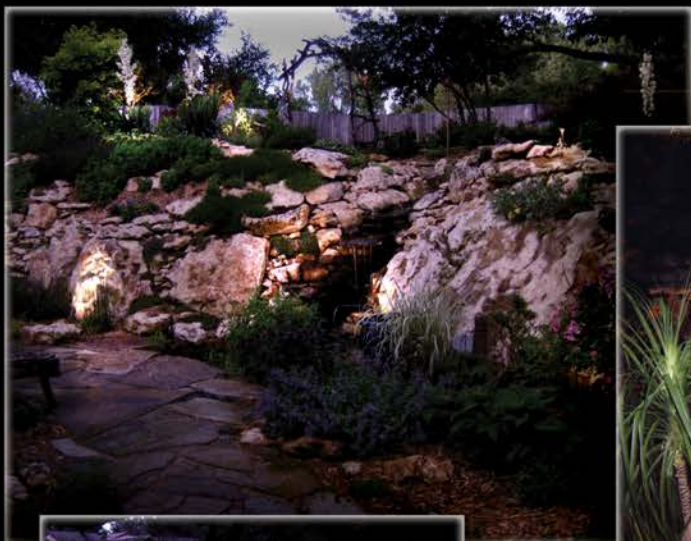

The advantages of landscape lighting include:

1. Your home can be beautiful at night too.
2. Increase security throughout your property.
3. Increase safety and illuminate trip hazards.
4. Create romantic places to relax and enjoy.
5. Reduce energy cost compared to 120 volt lights.
6. Lifetime warranty on bronze & copper fixtures.

DRAINAGE SYSTEMS

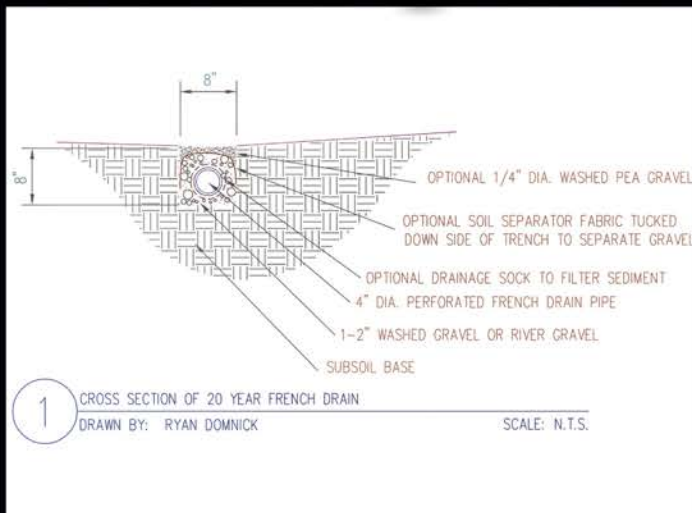

When it rains, you may experience standing water around your flower beds, lawn, patio or near your home's foundation. Our team of professionals at Low Maintenance Landscape can design and install the appropriate drainage solutions to fix these problems. A "french drain" is a perforated pipe surrounded with gravel. It is designed to catch water from a large yard area and channel it away from the house foundation. A "drain extension" is a buried solid pipe designed to catch water from a concentrated source like a gutter downspout and channel it away from the house foundation.

RAIN GARDENS

Rain gardens offer a way for homeowners to protect our environment and reduce flooding. A rain garden is a shallow depression that is planted with native wetland or wet prairie wildflowers and grasses. Rain gardens are strategically located to capture runoff from impervious surfaces such as roofs, driveways and roads. These landscaping features help create beautiful green spaces while absorbing water, reducing runoff, protecting water quality and preventing floods.



DRY RIVER BEDS

We construct stone dry river beds that recreate what you would find in nature. It is a beautiful landscaping approach used in sloping areas to help control erosion. Most of the time when the feature is dry, the stone will be the focal point. But when we do get that heavy rain storm, it will transform into a beautiful natural flowing stream.



Visit our web site at: LowMaintenanceLandscape.net

WATERGARDENS AND WATERFALLS

A water garden or waterfall will usually be the main visual attraction in the garden. This focal point will also create the soft relaxing sound of trickling water as you work or play. Constructing a good quality water garden is one of the most difficult niches in the field of landscape architecture. Our water gardens are carefully designed not to fail. We are always on the look out for potential problems; water will always try to find a way out as gravity is constantly working against us. Our water gardens will contain many extra features that inexperienced contractors may simply forget or omit because of cost. For example, all inside surfaces are lined with stone; this prevents accidental liner puncture when a neighbor's dog jumps in. In our decade of experience, we know all the tricks of mastering water.





Visit our web site at: LowMaintenanceLandscape.net

GROUNDCOVERS FOR DRY SHADE AND HILLSIDES

A groundcover area is simply a mass planting of one type of plant. This serves the same purpose of a lawn grass; to fill large areas of landscape space. Mowing and maintaining that water thirsty lawn under your large shade tree or on a hillside is expensive and time consuming! In the long run, you are fighting a losing battle in which the tree roots will out-compete lawn for water and nutrients. In general, groundcovers are tolerant of a wide range of soil types. By looking at your soil type, we can recommend the perfect groundcover even for that “nothing will grow there” soil. If you are having problems with barren areas in your lawn, you should consider groundcovers.



ADVANTAGES OF GROUNDCOVERS

1. Low maintenance qualities.
2. Uses very little water & nutrients.
3. Ability to choke out weeds.
4. Ability to tolerate foot traffic.
5. Beneficial to our environment.
6. Many will absorb fallen leaves.
7. Insulates tree roots from cold.
8. Will grow on steep slopes.
9. Will grow in "dry shade" areas.
10. Attractive foliage and flowers.

BROADLEAF EVERGREEN TREES AND SHRUBS

Broadleaf evergreen trees and shrubs provide much-needed winter color in cold climates. Broadleaf evergreens provide a few key advantages over coniferous evergreens. Broadleaf evergreens offer superior disease resistance, bright green, red or purple winter color, plenty of cold hardiness, and in many cases flowers and berries.



Visit our web site at: LowMaintenanceLandscape.net



HARDY TROPICAL GARDENS

Hardy tropical plants create the feeling of a lush, relaxing, low stress environment. These plantings create the mood of being in a warm, happy, tropical place. The typical cold hardy tropical will have either large leaves, large flowers, bold texture or lots of contrast. Surprisingly, many of these plants such as needle palm and hardy banana will grow here if placed in the right microclimate! Typically being zone 6 or 7 plants, they are perfectly happy next to a hot south or west wall that will burn most plants that aren't heat tolerant. They can be treated like normal perennials, only requiring extra mulch to survive the winter.

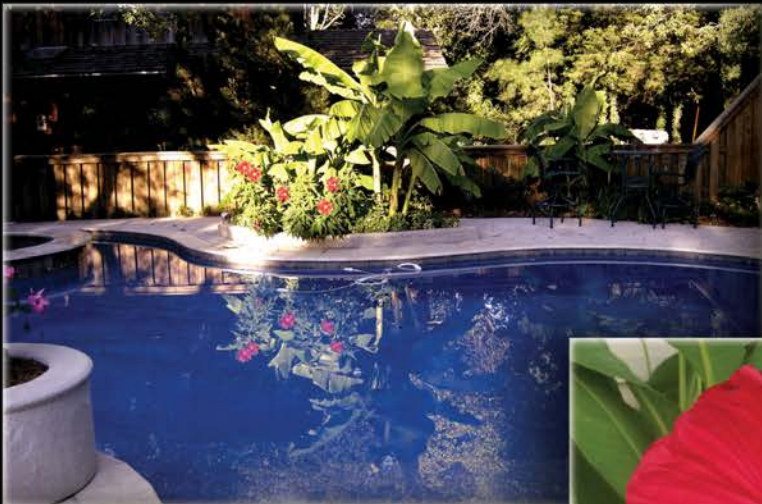
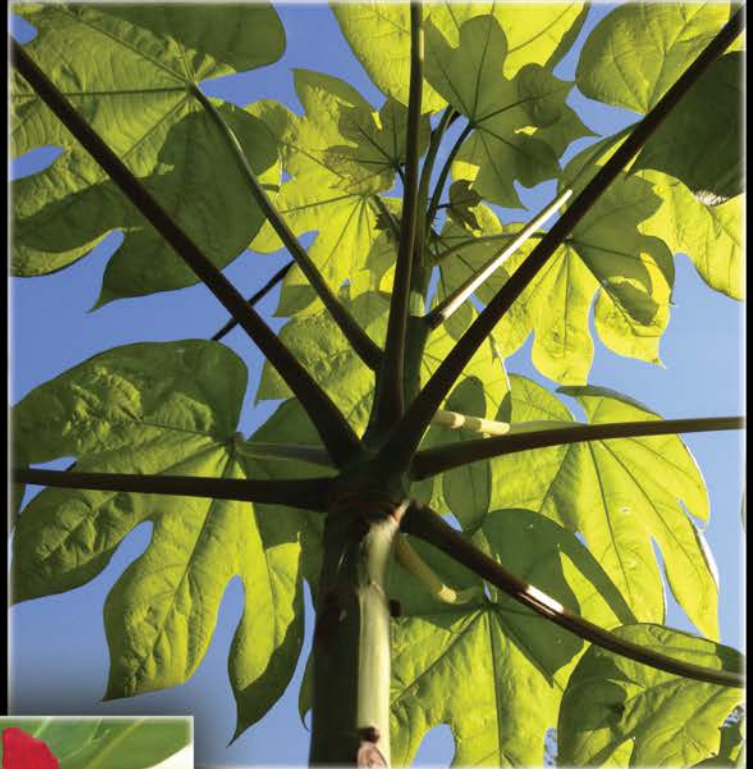

MISTING SYSTEMS

Cool off in the summer heat with a custom designed misting stand!



EVERGREEN BAMBOO SCREENS AND WALLS

You have reason to be skeptical of planting bamboo because it can take over your yard. Many homeowners and inexperienced landscapers have improperly planted bamboo and given it a bad reputation. Low Maintenance Landscape is one of the only companies with the knowledge and experience of how to contain bamboo in the landscape and utilize all of its wonderful assets.



A large evergreen bamboo screen can completely hide the view of a neighbor's house, block traffic noise from a busy street and provide shelter from wind. Bamboo is often used to create evergreen privacy walls because there is no other plant that can match the density of bamboo. We often recommend bamboo for dry shade areas under large trees where no other evergreen will grow. A grove is usually contained with a plastic underground rhizome barrier. Bamboo is also used in open lawn areas where it can be maintained by normal mowing around the perimeter.

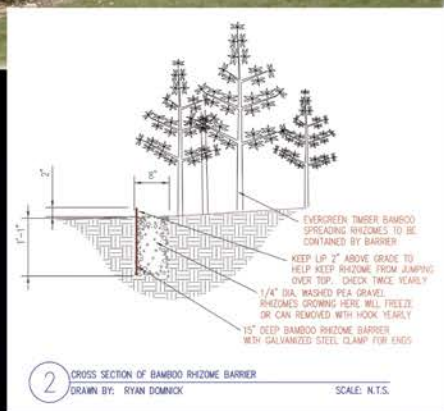

BUFFALO GRASS LAWNS

Buffalo grass is the native choice for an environmentally friendly lawn. Unlike fescue or bluegrass, this lawn grass uses only 1/4 inch of water per week to stay green. It only needs mowing every 3-6 weeks. Buffalo grass is dense, fine textured, and maintains a beautiful medium green color during the growing season. It does best where it gets full sun, dry clay soil, and a taller mowing height of 4".

Visit our web site at: LowMaintenanceLandscape.net

NATIVE PRAIRIE GARDENS

Many of our gardens are designed to survive and open, windswept, full sun prairie environments. Native plants are often best adapted for these harsh conditions. Most prairie natives require no extra water once established. Native prairie gardens also friendly to butterflies, bees, and birds.



DRIFTWOOD SCULPTURES

We love to incorporate art into the garden.



BERM CONSTRUCTION AND PLANTING

Well constructed berms provide interest to an otherwise flat landscape. Berms also provide height, noise screening and wind protection. They also help direct traffic and create physical barriers to automobiles. A well proportioned and properly planted berm will require a lot of soil to create a focal point; perfect if you have a leftover pile of dirt from a construction project.



EDIBLE LANDSCAPING

We like to incorporate edible plantings into our landscapes whenever possible. It's nice to be able to eat your plants too!



GARDEN BEDS

Our garden beds are constructed to be long lasting are free of harmful wood preservative chemicals.



Visit our web site at: LowMaintenanceLandscape.net

MINIMALIST GARDENS

Minimalist gardens may sound plain and boring to some but simple and stylish to others. Elegance is achieved by using a restricted pallet of hardscaping materials and plants combined to create a bold simple statement. Repeating neutral colors, textures, and shapes are typical of a minimalist garden. Usually, we will highlight only one or few architectural elements. This will create an uncluttered look with plenty of tranquil open space for you to enjoy.



MULCHING

We offer spring mulching service. Mulch helps stop weeds, protects plant roots from cold and heat and conserves water during drought.



LEAF REMOVAL

We offer fast and efficient leaf removal service in fall and winter.



LANDSCAPE MAINTENANCE

We specialize in offering knowledgeable landscape and garden maintenance services to homeowners and small commercial buildings! We provide custom service for many different landscape situations. Many of our customers already have a beautiful, well-maintained landscape and need an expert horticulturist to provide on-going maintenance and monitoring for problems. Some of our new customers have an overgrown landscape in desperate need of a complete clean-up and pruning. Others wish their yard looked nice but don't know what to do or where to start. We also provide service to those who just need seasonal help.

Your landscape is a valuable part of your home investment. Did you know that an attractive, well-designed and maintained landscape raises the value of your property by 10 to 15%? Let our professionals with a degree in landscape architecture and horticulture with over 30 years of experience take care of these needs for you! We take pride in operating a small, locally owned business. Offering the best customer service and personal care is our top priority! We work with your needs and your budget. For each job site we visit, we determine what tasks need to be done, and knock them out efficiently.



Visit our web site at: LowMaintenanceLandscape.net



SUSTAINABLE, ORGANIC, LOCALLY GROWN PLANTS

A majority of our landscape plants are grown right here at our local nursery. Locally grown plants in real topsoil are less likely to suffer from transplant shock when planted in your landscape. We believe in using mostly organic growing methods and grow mostly self-sustainable varieties. We grow a mix of native plants as well as introduced plants from similar environments around the world. We also grow many unusual plants including cold hardy tropicals. Our nursery is open to wholesale customers by appointment. Anyone can sign up to be a wholesale customer with an initial \$100 minimum purchase.

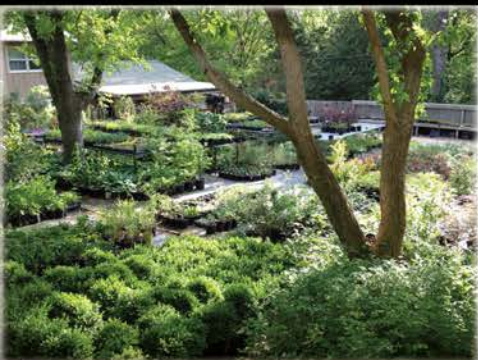

ANNUAL PLANTINGS

Annuals are great for adding intense bright color to the landscape all summer long!



SPRING BULB PLANTINGS

Mass plantings of spring bulbs add color to the landscape in early spring!



PATIO PLANTS, DECK PLANTS AND SUCCULENTS

Patio and deck plants provide the finishing touch to a landscape. Many of these plants can be overwintered inside a house or garage.

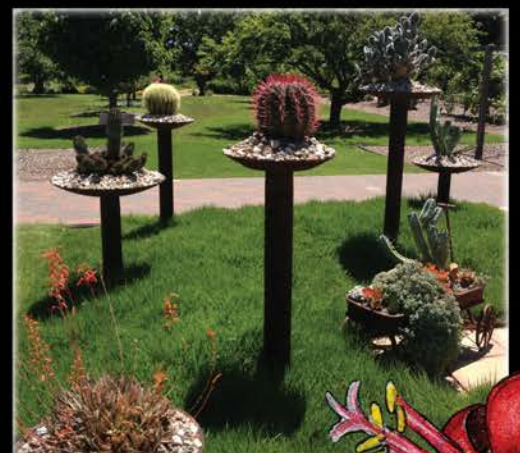

Visit our web site at: LowMaintenanceLandscape.net



COMMERCIAL PROJECTS

Commercial landscape projects can also have the same beauty and look of our residential low maintenance landscapes. We artistically combine the beauty and texture of flowering and evergreen plants to create an elegant but simplistic look with four seasons of interest. From a maintenance standpoint, shrub and perennial beds only require monthly maintenance compared to weekly maintenance of a lawn area. Commercial plantings we specify must survive all of the normal environmental challenges of a residential landscape including extra foot traffic.





Visit our web site at: LowMaintenanceLandscape.net



LANDSCAPE PROJECT PORTFOLIO

We specialize in the art of designing beautiful landscapes that require much less upkeep and maintenance than conventional landscapes. We would love to show you our diverse portfolio of beautiful landscape and hardscape projects we have designed and installed over the past decade. Please give us a call today.

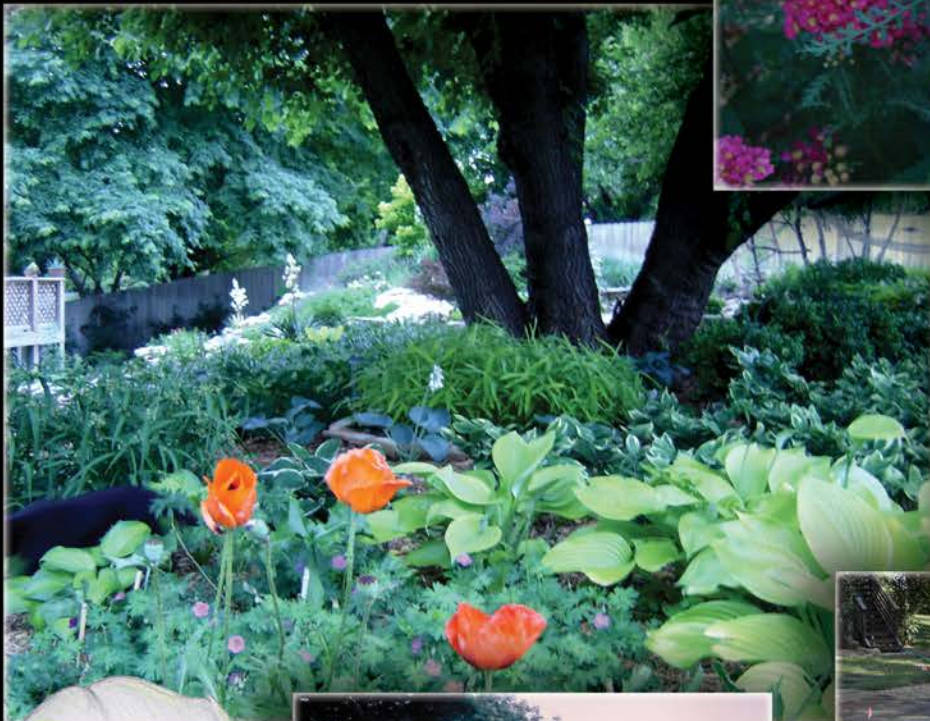

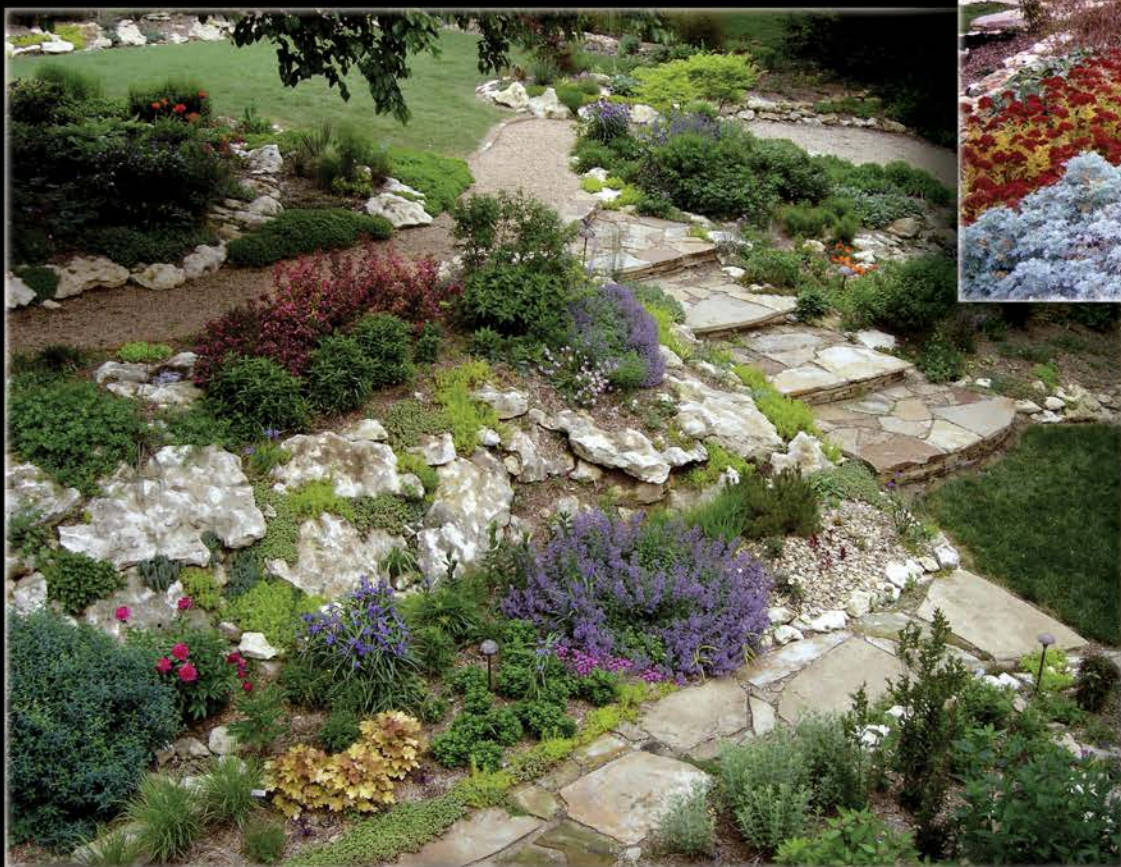
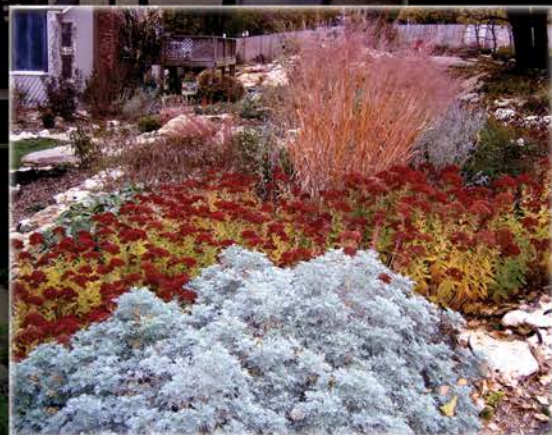

Visit our web site at: LowMaintenanceLandscape.net



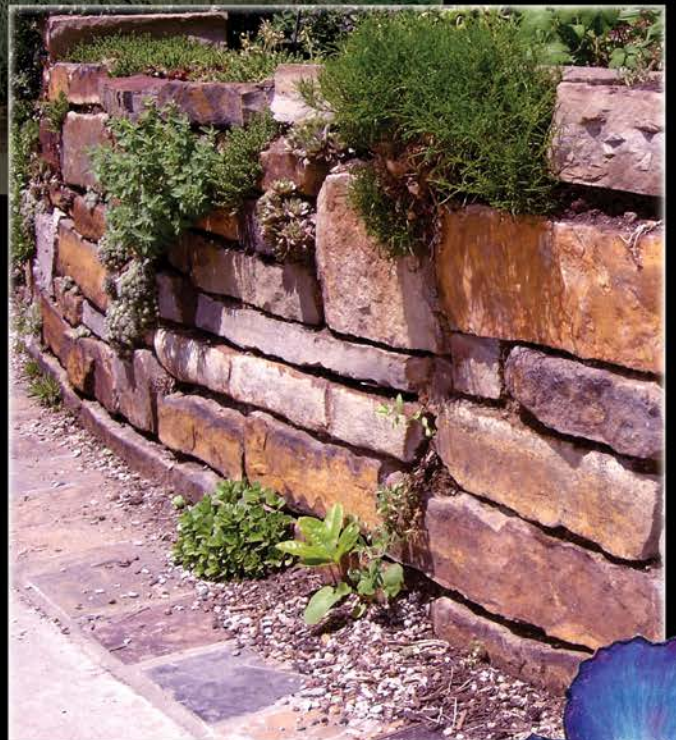

Visit our web site at: LowMaintenanceLandscape.net

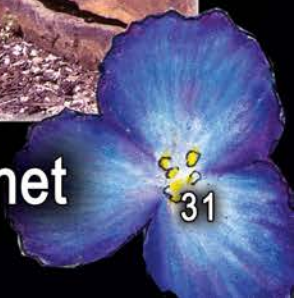

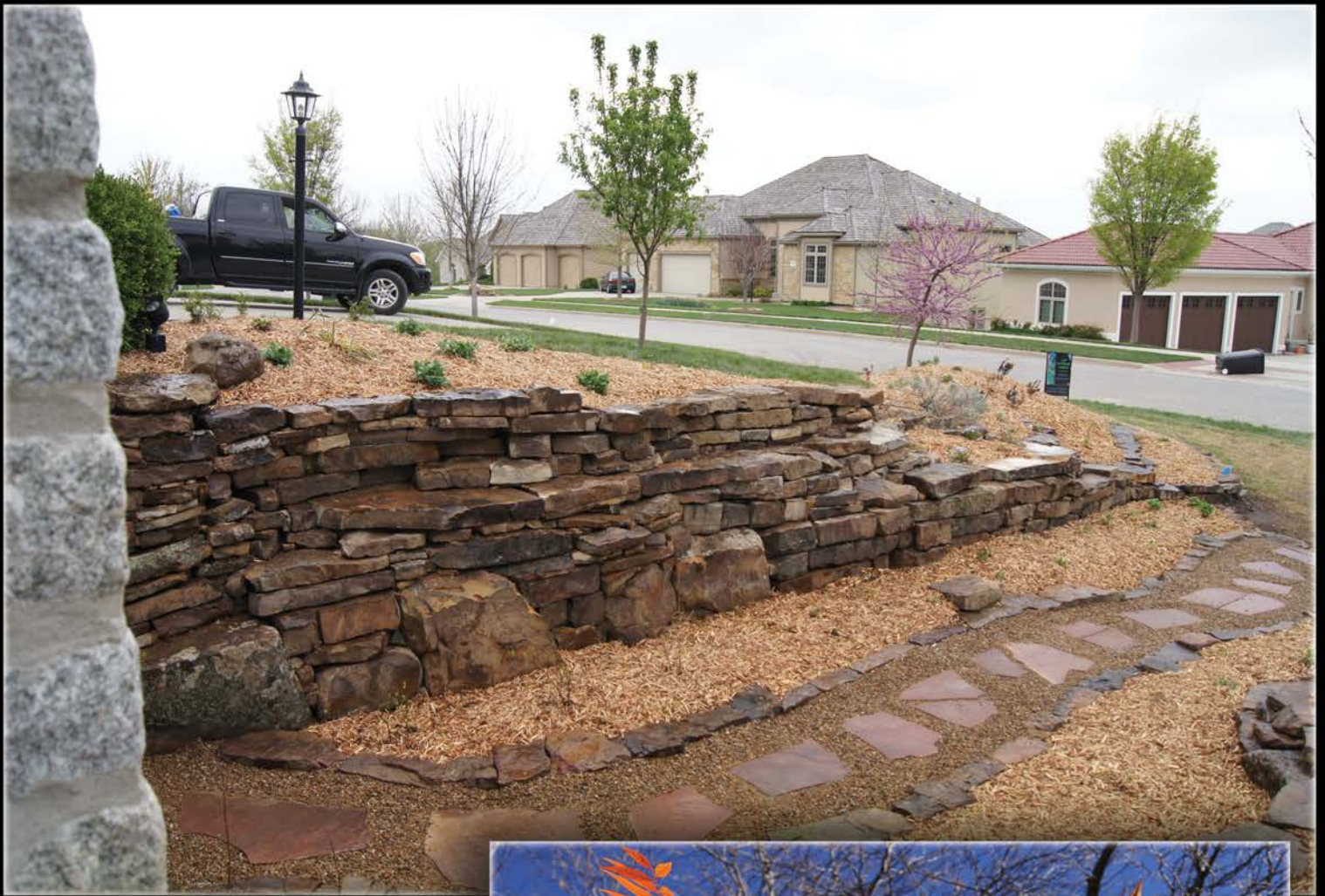



Visit our web site at: LowMaintenanceLandscape.net

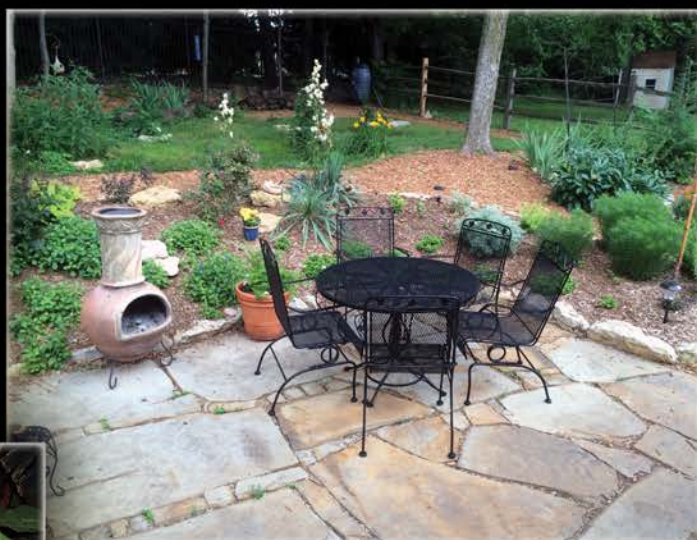



Visit our web site at: LowMaintenanceLandscape.net

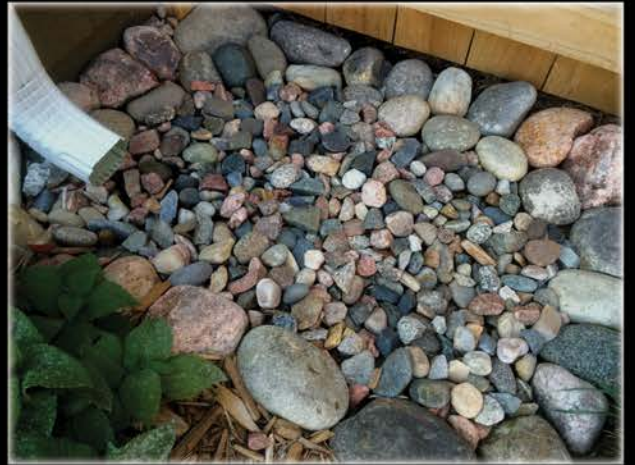



Visit our web site at: LowMaintenanceLandscape.net





Visit our web site at: LowMaintenanceLandscape.net

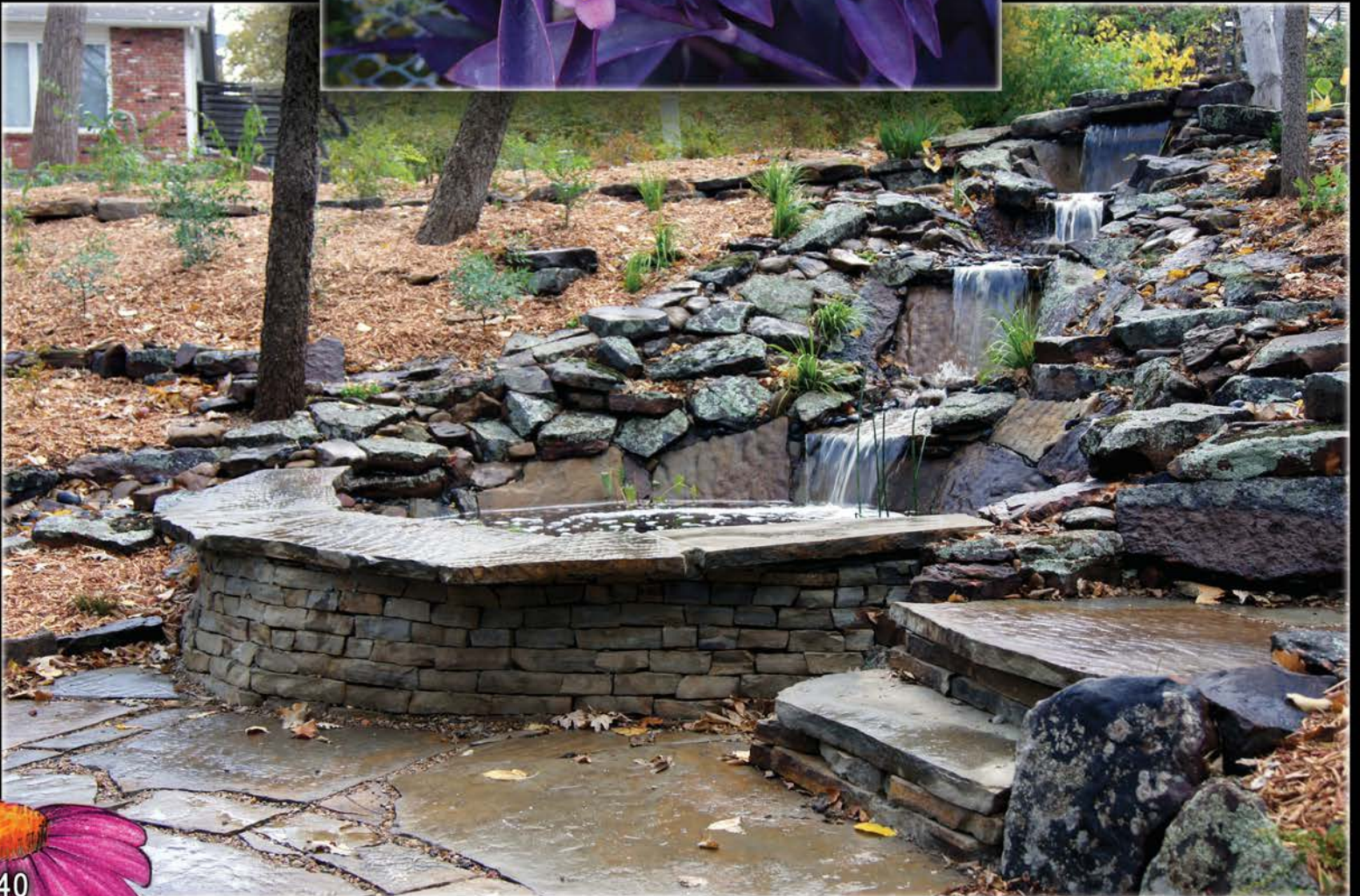

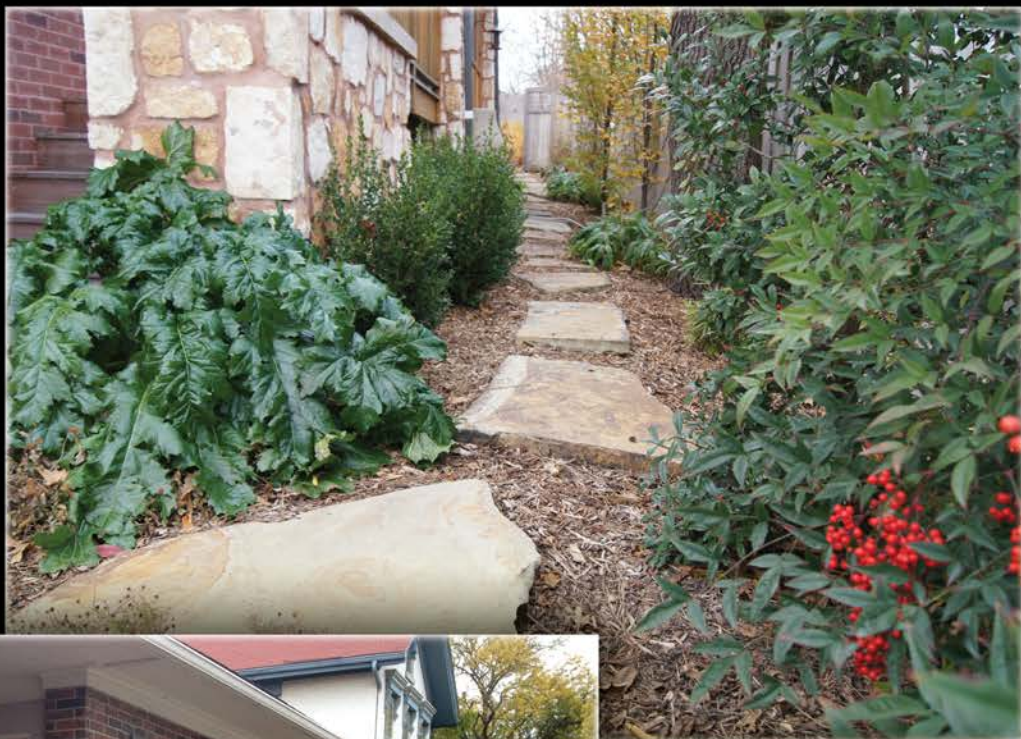

Visit our web site at: LowMaintenanceLandscape.net





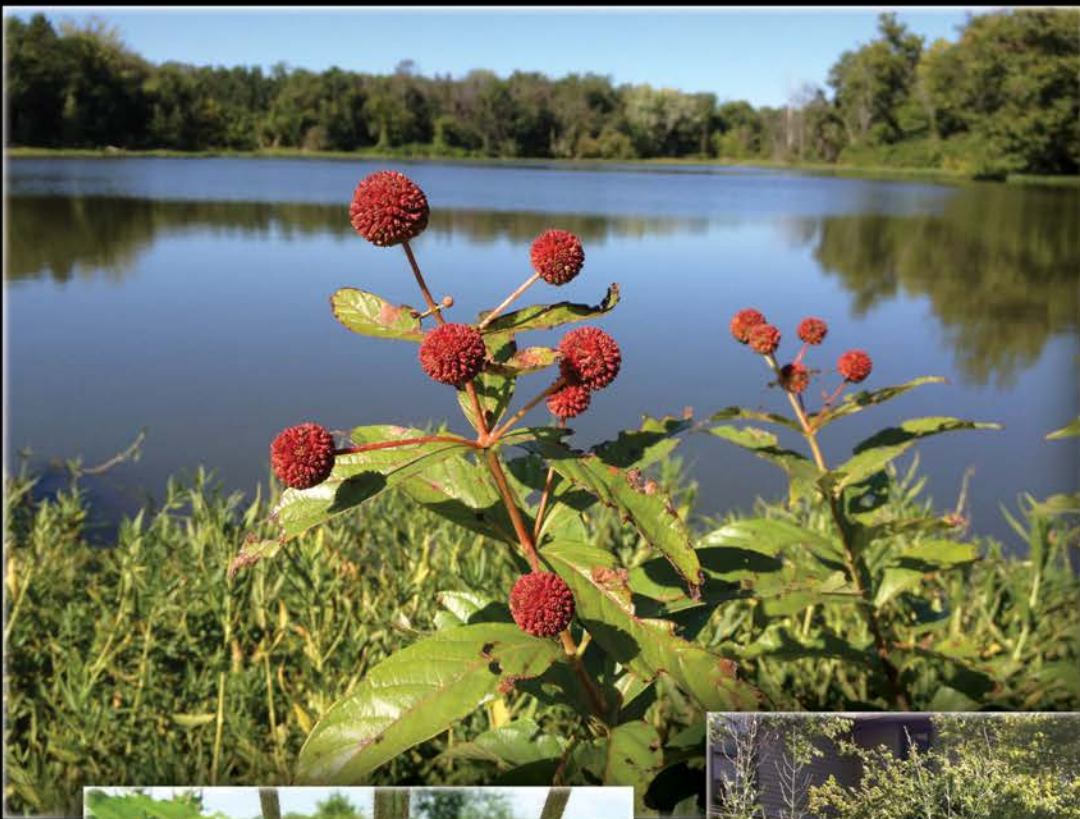

Visit our web site at: LowMaintenanceLandscape.net

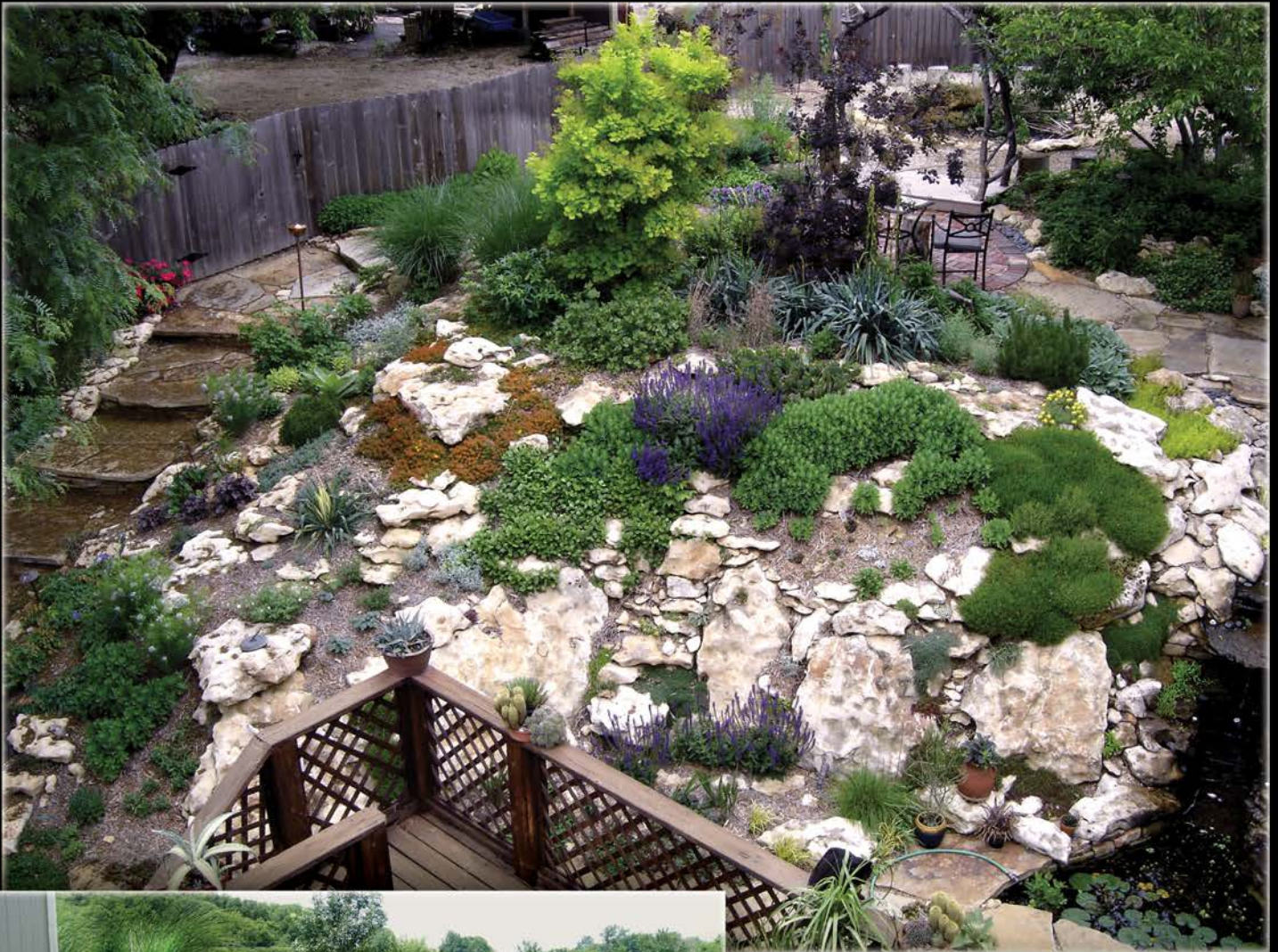



Visit our web site at: LowMaintenanceLandscape.net





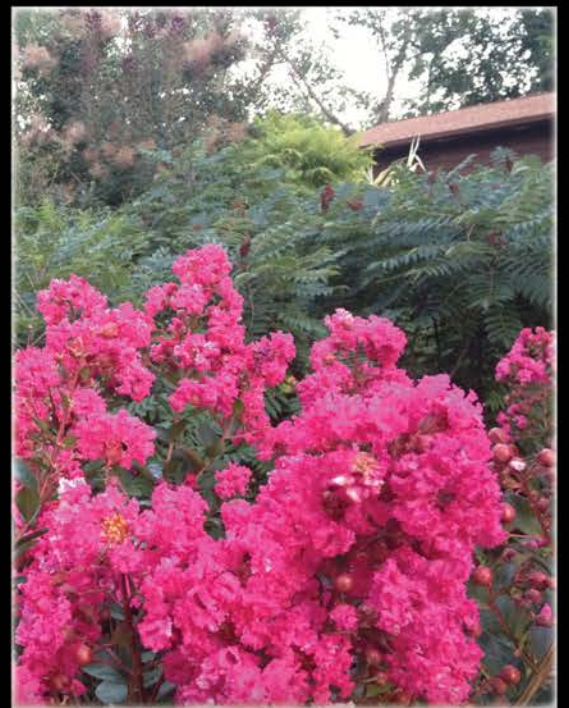

Visit our web site at: LowMaintenanceLandscape.net





Visit our web site at: LowMaintenanceLandscape.net

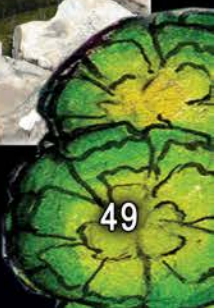





Visit our web site at: LowMaintenanceLandscape.net





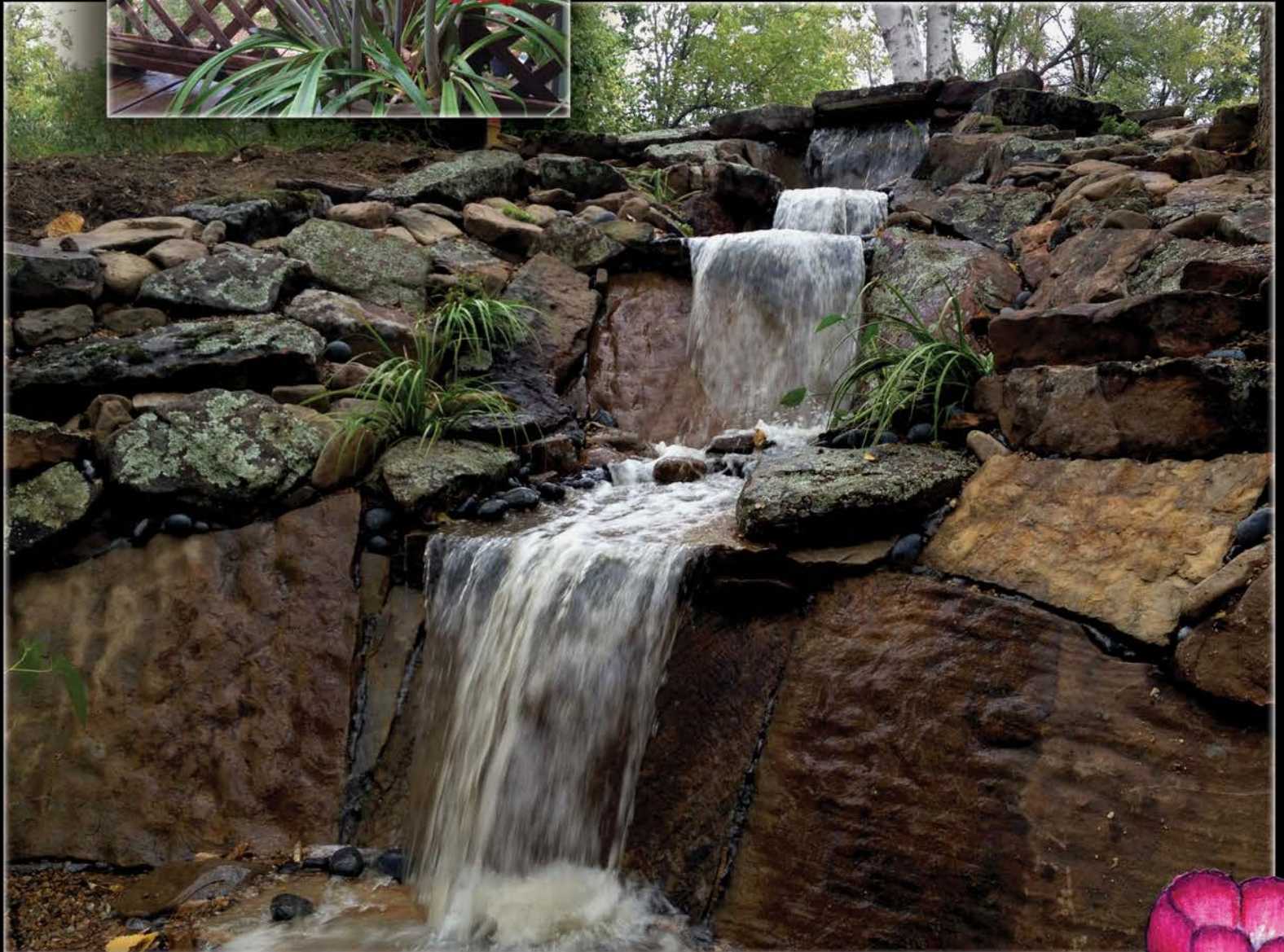

Visit our web site at: LowMaintenanceLandscape.net







Visit our web site at: LowMaintenanceLandscape.net







Visit our web site at: LowMaintenanceLandscape.net



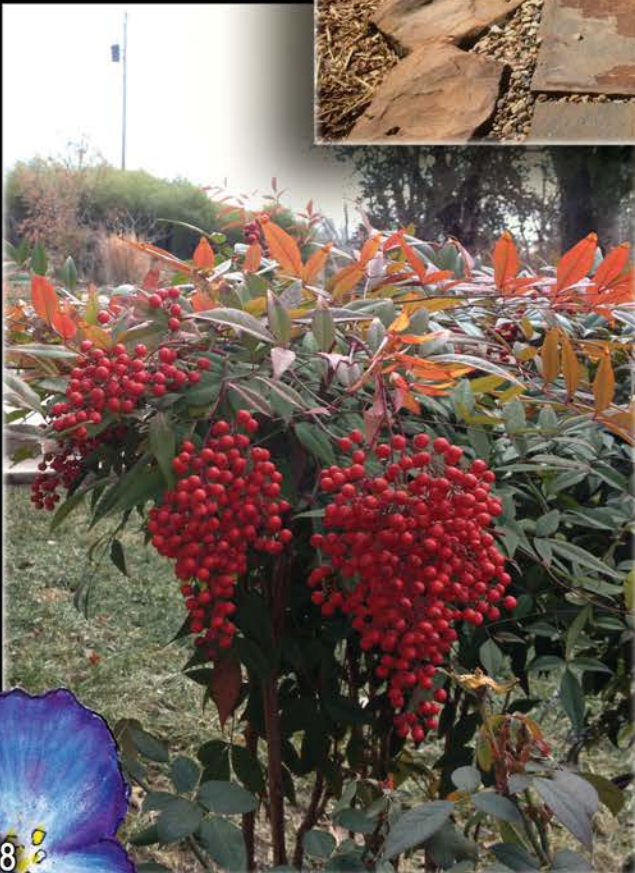
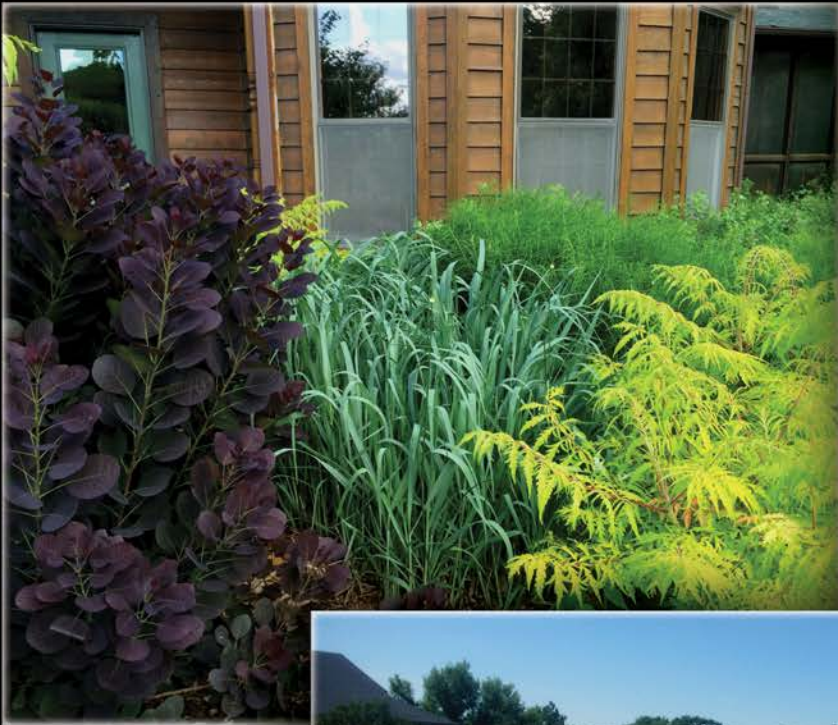



Visit our web site at: LowMaintenanceLandscape.net





Visit our web site at: LowMaintenanceLandscape.net





Visit our web site at: LowMaintenanceLandscape.net





Visit our web site at: LowMaintenanceLandscape.net

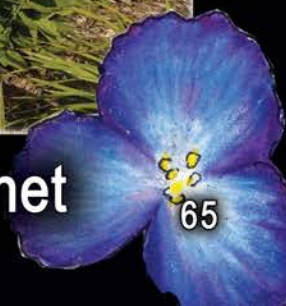



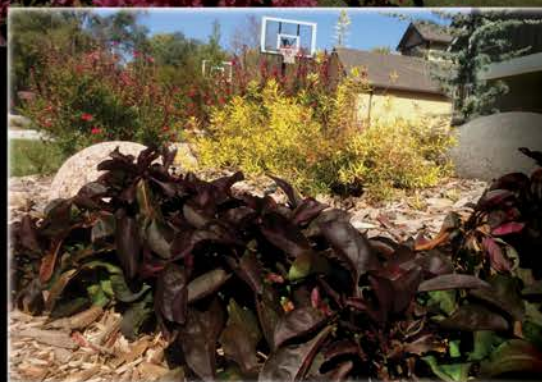

Visit our web site at: LowMaintenanceLandscape.net

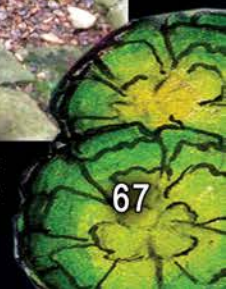





Visit our web site at: LowMaintenanceLandscape.net



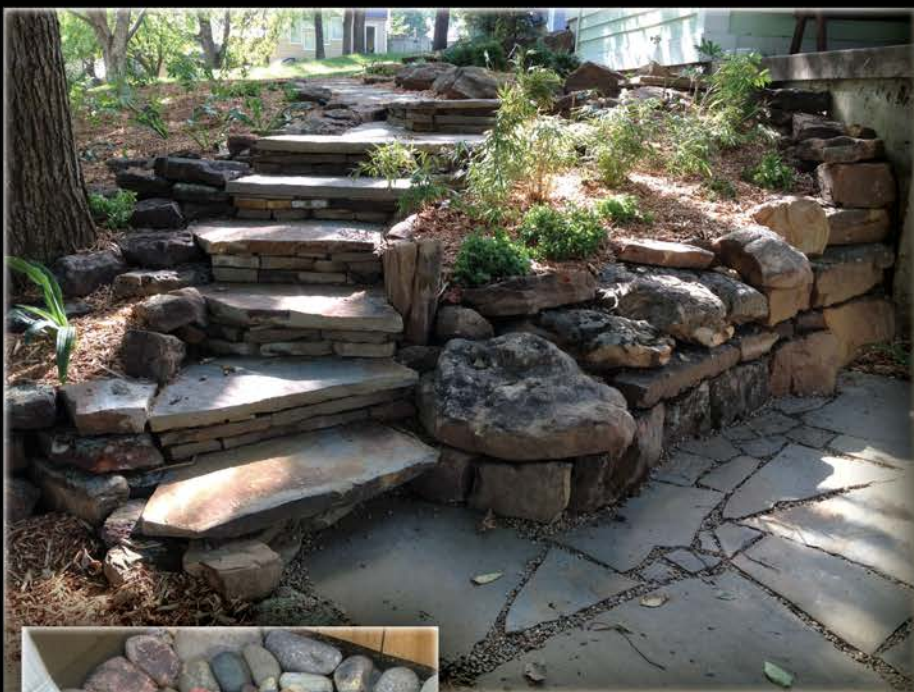

Visit our web site at: LowMaintenanceLandscape.net



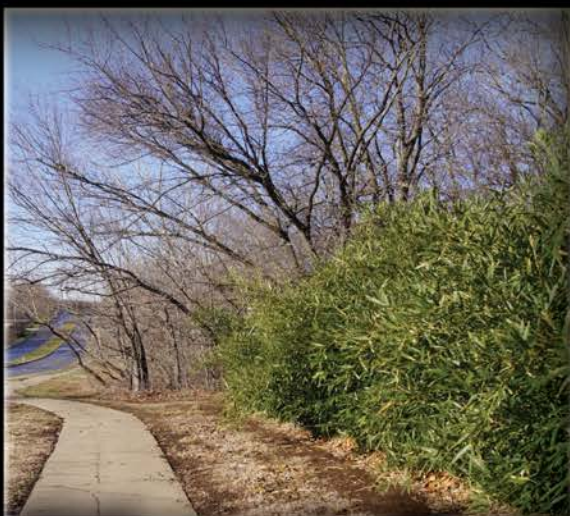

Visit our web site at: LowMaintenanceLandscape.net





Visit our web site at: LowMaintenanceLandscape.net



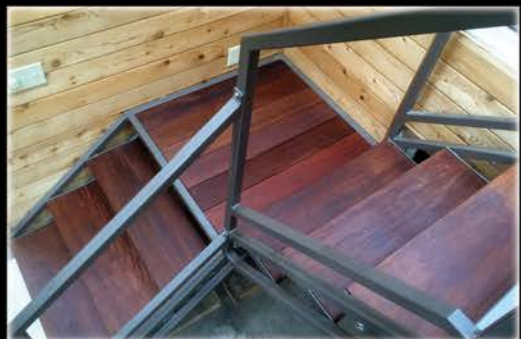
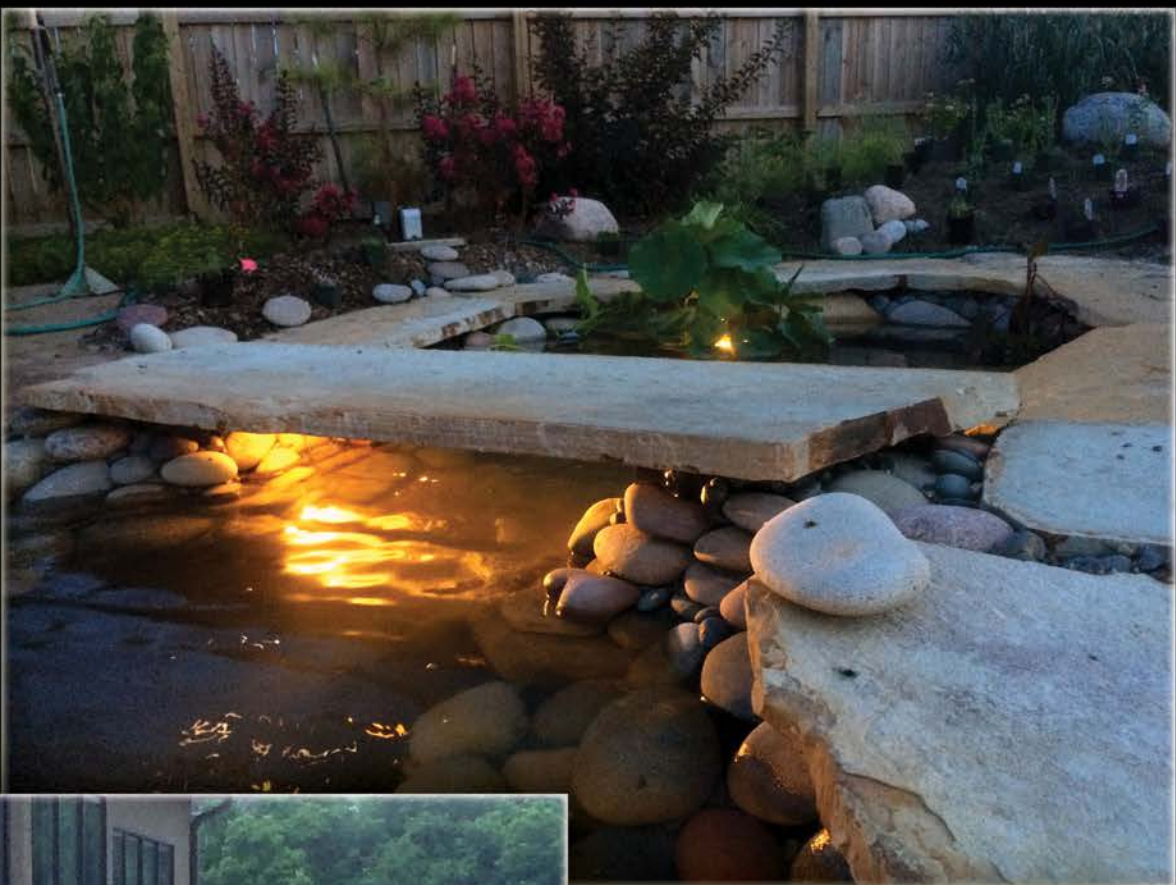



Visit our web site at: LowMaintenanceLandscape.net

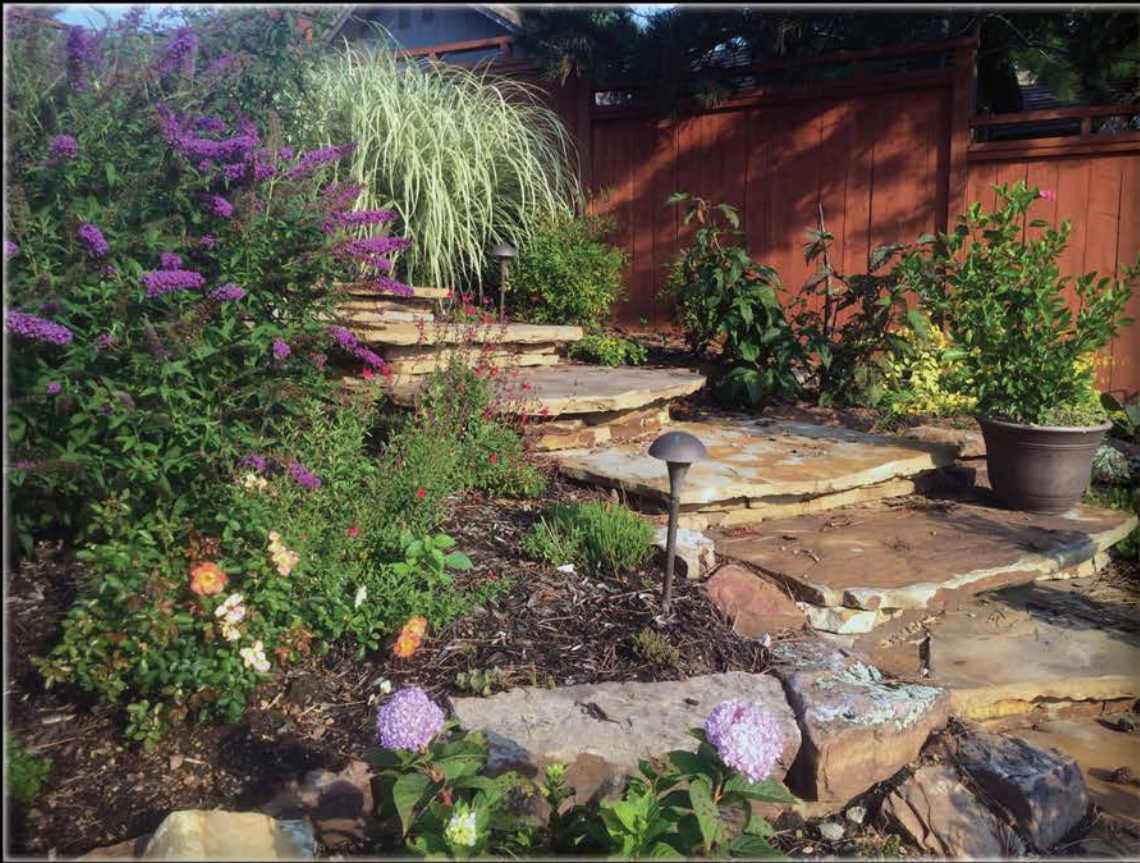

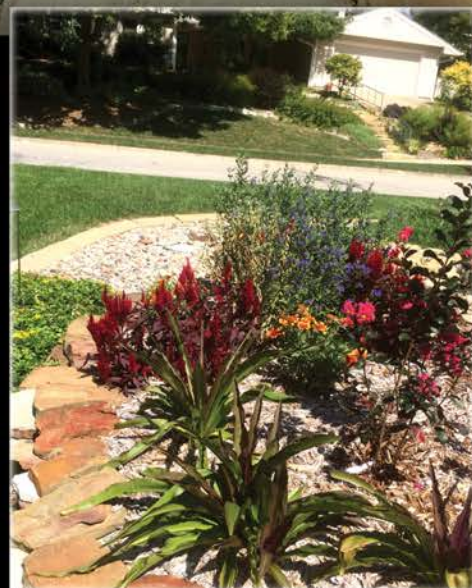

Visit our web site at: LowMaintenanceLandscape.net

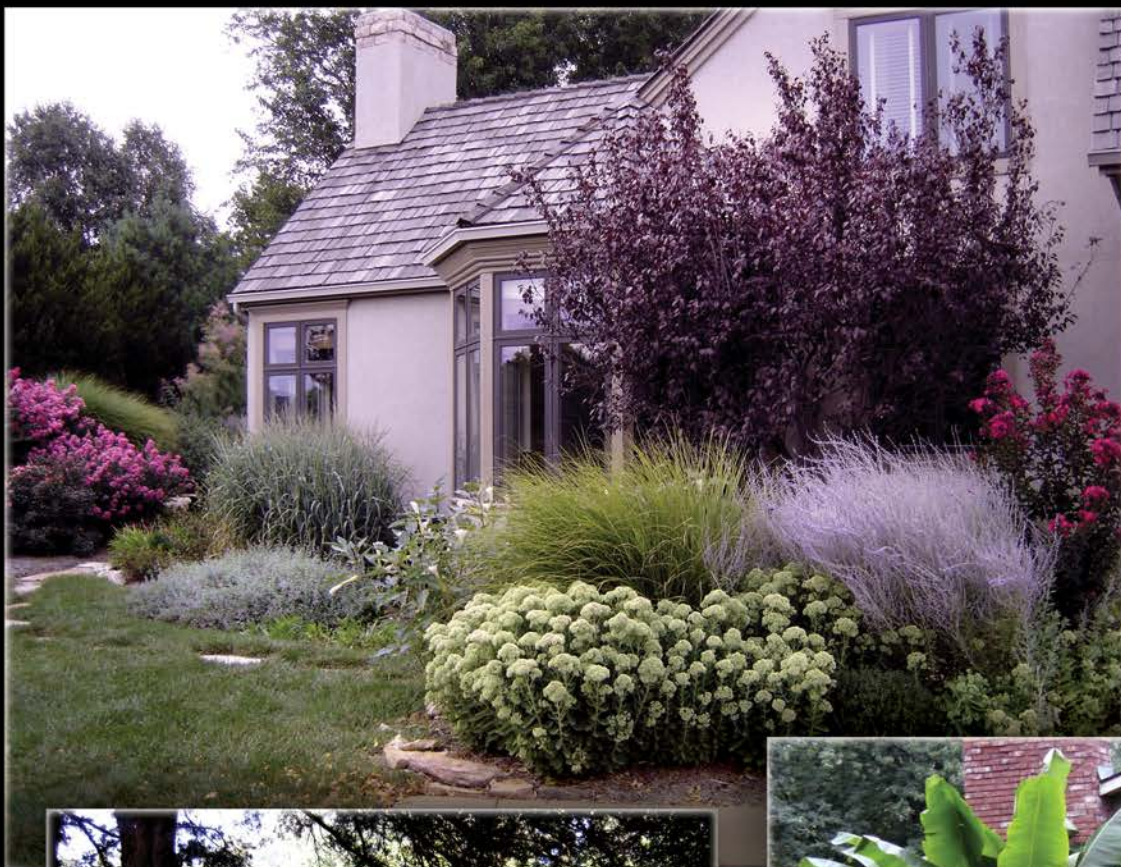



Visit our web site at: LowMaintenanceLandscape.net



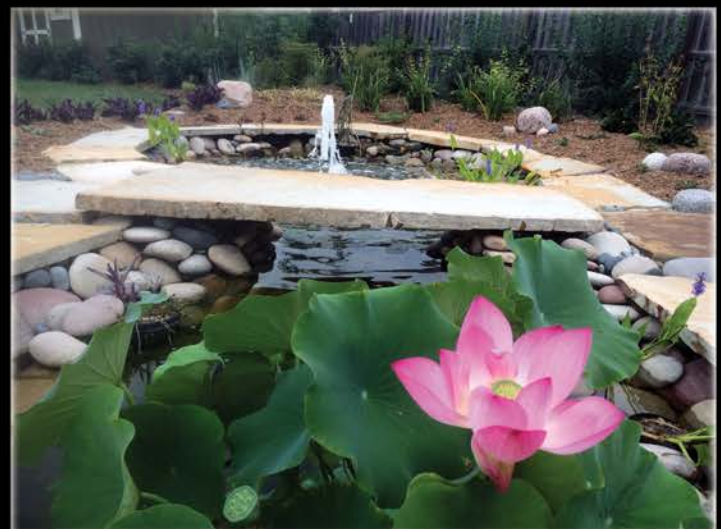

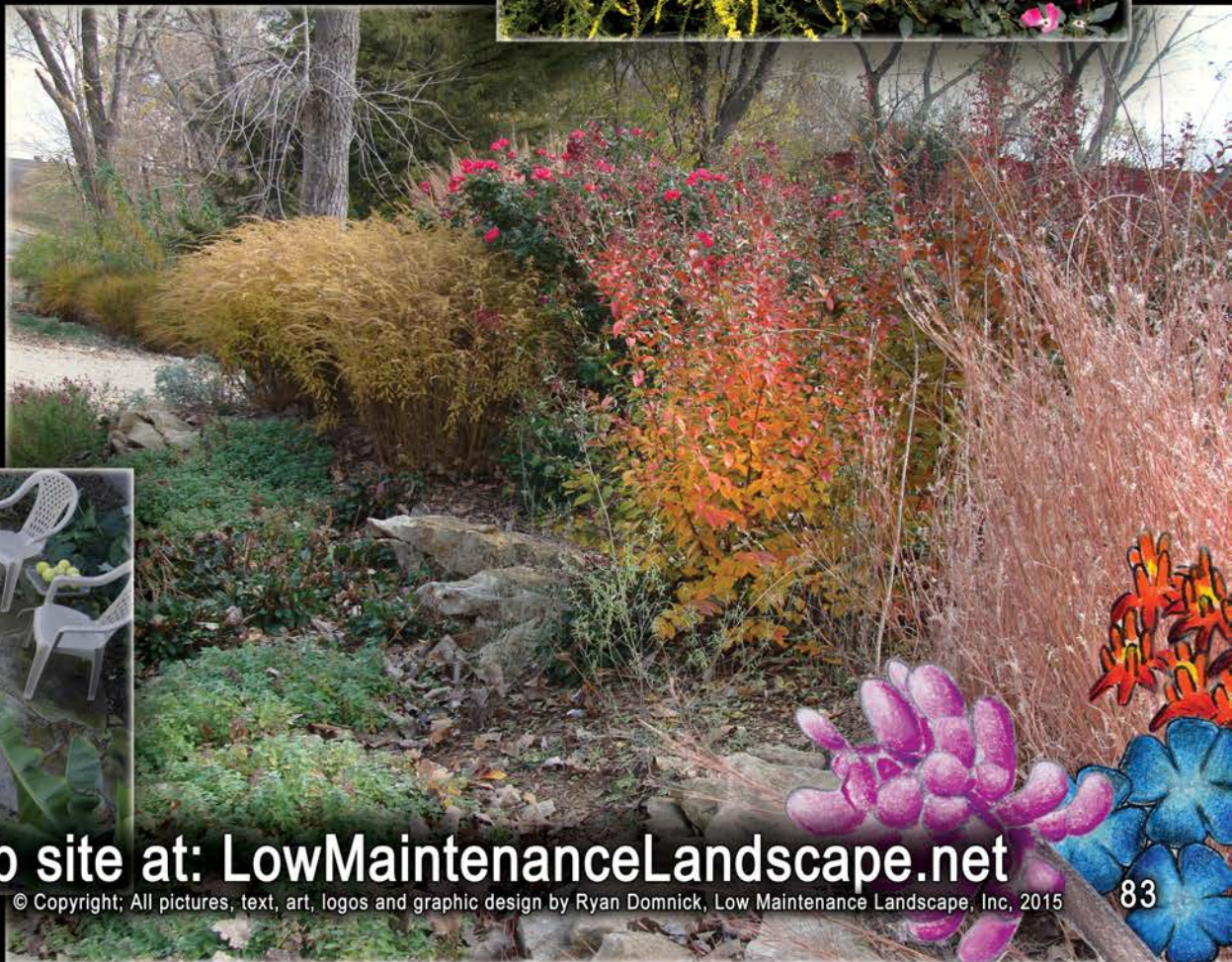

Visit our web site at: LowMaintenanceLandscape.net

© Copyright; All pictures, text, art, logos and graphic design by Ryan Domnick, Low Maintenance Landscape, Inc, 2015



LOW MAINTENANCE LANDSCAPE inc.

DESIGN . CONSTRUCTION . MAINTENANCE



LOW MAINTENANCE LANDSCAPE, INC.

1210 LAKEVIEW CT.

LAWRENCE, KS 66049

785-550-5610

ryan@lowmaintenancelandscape.net

Visit our web site at: LowMaintenanceLandscape.net

